



# 14 Heaton Court 14 Denham Road

, London, N20 0EE

**Offers Over £319,500**

 2
  1
  1
  B

## Property features

Two Bedrooms  
 Second Floor  
 Balcony  
 Gated Development  
 Oakleigh Park Station 0.9 Miles & Totteridge & Whetstone Station 1 Mile  
 Property description

## Summary





Area Map

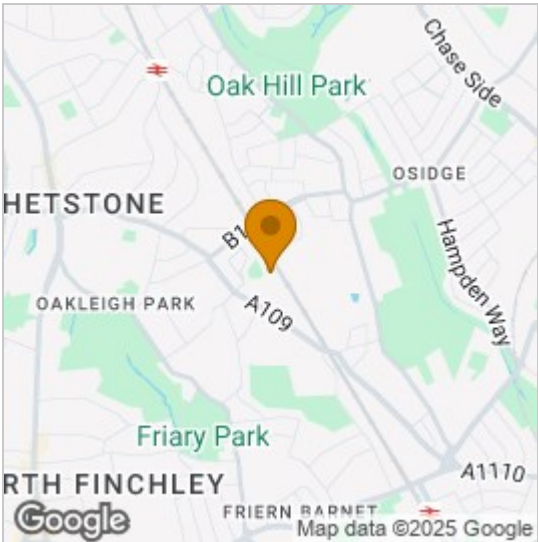

Floor Plans

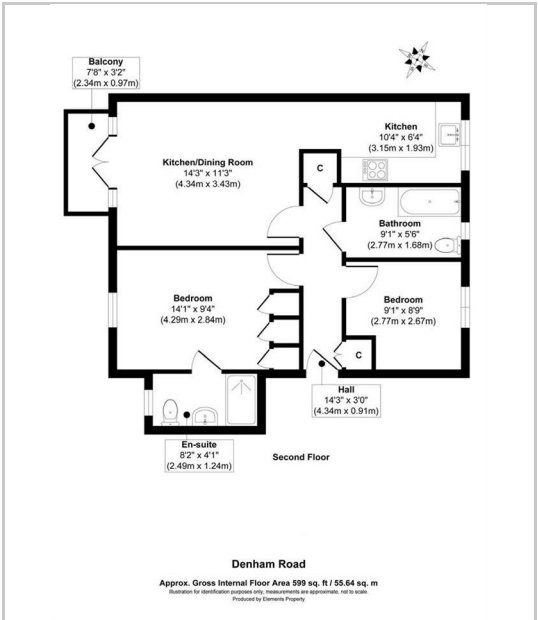

Energy Efficiency Graph

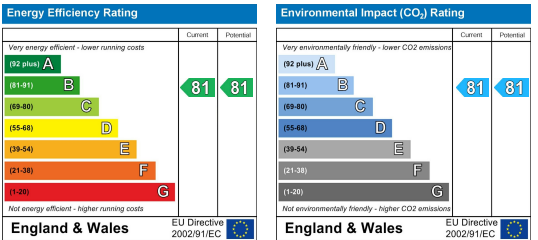

These particulars, whilst believed to be accurate are set out as a general outline only for guidance and do not constitute any part of an offer or contract. Intending purchasers should not rely on them as statements of representation of fact, but must satisfy themselves by inspection or otherwise as to their accuracy. No person in this firms employment has the authority to make or give any representation or warranty in respect of the property.